

State of Wyoming Corner Record

(In compliance with the *CORNER PERPETUATION AND FILING ACT*, Wyoming Statutes, 1997, Section 33-29-140, et seq., and the Rules and Regulations of the Board of Registration for Professional Engineers and Professional Land Surveyors)

Reverse side of this form may be used if more space is needed.

Record of original survey and citation of source of historical information (if corner is lost or obliterated). Description of corner monumentation evidence found and/or monument and accessories established to perpetuate the location of this corner. Sketch of relative location of monument, accessories, and reference points with course and distance to adjacent corner(s) (if determined in this survey). Method and rationale for reestablishment of lost or obliterated corner.

GLO Record: Alfred M. Rogers, U.S. Deputy Surveyor, June 1871

N 89° 18' E on a True line between Sections 6 & 7, 38.85 Chains Set a Red Sandstone 14 x 8 x 6 for 1/4 Section corner.

Found: Laramie County Road No. 220, No evidence of original Stone. Found Fence line South of proportioned location of 1/4 Corner.

Set: Set 3 1/4 inch aluminum cap 2 inches under road surface inscribed Cornerstone Surveying Co - WY PLS 555 attached to a 5/8 x 24 inch rebar.

From the Set Monument:

A found 2 1-2 inch Aluminum cap at Northwest corner of Section 7 as recorded on the State of Wyoming Corner Recordation form E-1 of T15N R63W of the records of the Laramie County Clerk, bears S 89° 00" 18" W a distance of 2560.79 feet.

A found 2 1-2 inch Aluminum cap at Northeast corner of Section 7 as recorded on the State of Wyoming Corner Recordation form E-5 of T15N R63W of the records of the Laramie County Clerk, bears N 89° 00" 18" E a distance of 2636.60 feet.

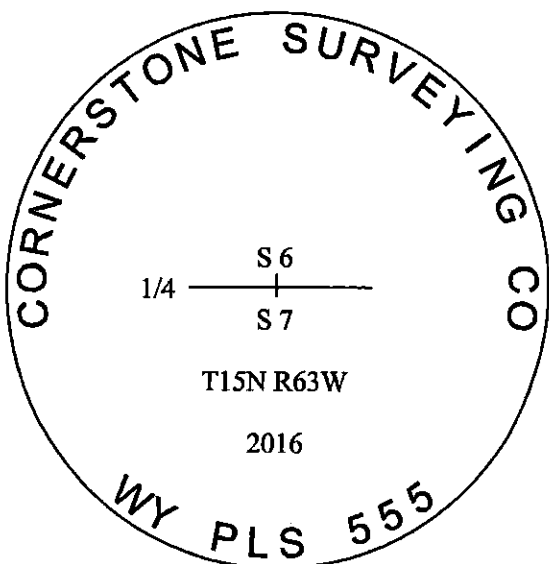

RECP #: 693744
RECORDED 10/11/2016 AT 10:26 AM BK# 2519 PG# 7
Debra K. Lee, CLERK OF LARAMIE COUNTY, WY PAGE 1 OF 1

Date of Field Work: 09/15/2016

Office Reference: 2016-7 TRAY

CROSS INDEX DIAGRAM

	1	2	3	4	5	6	7	8	9	10	11	12	13	14	15	16	17	18	19	20	21	22	23	24	25
A																									
B																									
C																									
D																									
E																									
F																									
G																									
H																									
J																									
K																									
L																									
M																									
N																									
O																									
P																									
Q																									
R																									
S																									
T																									
U																									
V																									
W																									
X																									
Y																									
Z																									

Land Surveyor / Firm / Address

S. D. DAWSON

CORNERSTONE SURVEYING CO

4005 SNYDER AVENUE

CHEYENNE, WYOMING 82001

Telephone: 307-421-9932

This corner record was prepared by me or under my direction and supervision.

SEAL & SIGNATURE



Corner Name: N 1/4

SBRPEPLS/PLSW: March 1994; PLSW January 1998

Section: 7 T 15 N R 63 W; 6TH P.M. Cross-Index No.: E-3